



**PROTON**

*It's in the Drive!*

A Member of  
**DRB-HICOM**

**PERUSAHAAN OTOMOBIL NASIONAL SDN. BHD. (100995-U)**

HICOM Industrial Estate, Batu 3,

P.O Box 7100, 40918 Shah Alam,

Selangor Darul Ehsan, Malaysia.

T +603 51911055 F +603 51911252

Part No.: PW944735

[proton.com](http://proton.com)

**PROTON Customer Care 1 800 888 398**

# Proton **PERSONA**

QUICK GUIDE



**PROTON**

*It's in the Drive!*

A Member of  
**DRB-HICOM**

This quick guide is not intended to replace the Owner's Manual. Owner should always refer to the Owner's Manual for clear understanding to avoid any complication during the vehicle's operations, and to read all precautions and notes as highlighted in the Owner's Manual.

## Remote transmitter

To use the key

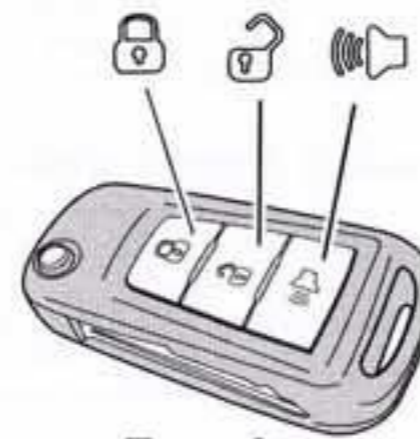
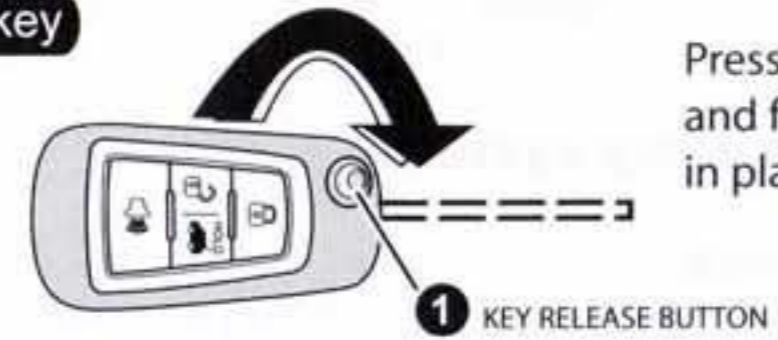

Type A



Type B

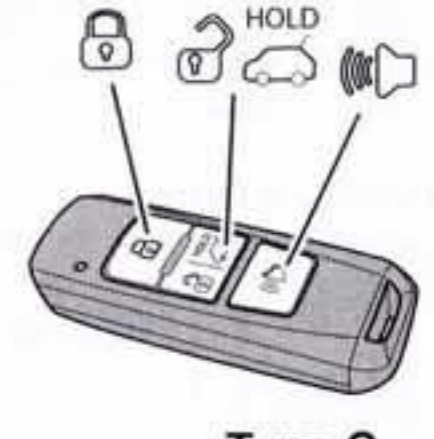

Type C

Features		Type A	Type B	Type C
Locking		✓	✓	✓
Unlocking		✓	✓	✓
Panic		✓	✓	✓
Trunk lid remote release		Not applicable	✓	✓
Keyless entry		Not applicable	Not applicable	✓



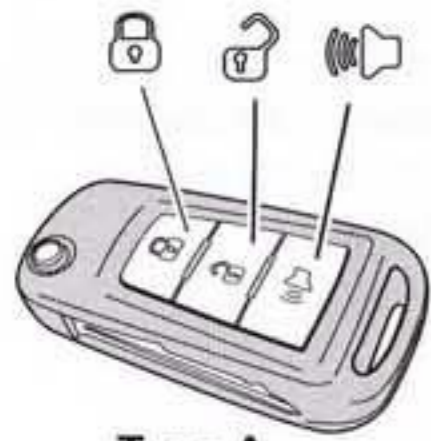

Type A

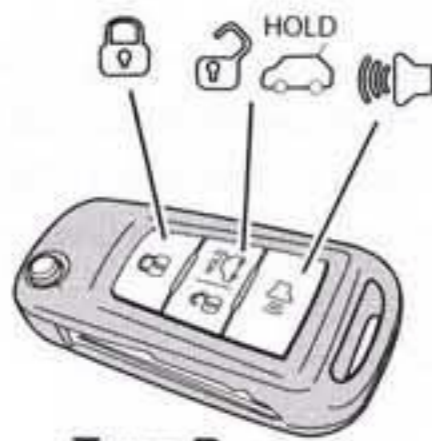

Type B

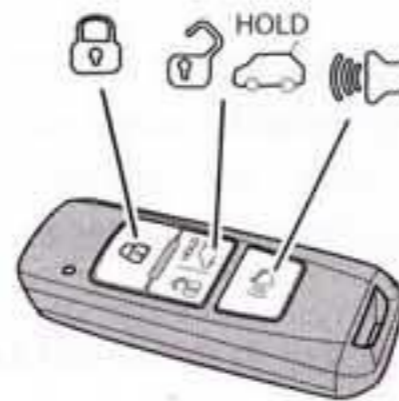

Type C

## Remote keyless entry system

### Central lock / unlock



Press to unlock all doors.  
Press to lock all doors.

### Panic alarm



Press to activate panic alarm.

### Trunk lid remote release (for some types)

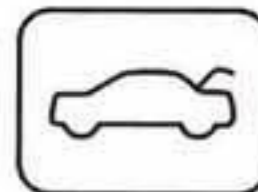

Press for more than 3 seconds to unlock the trunk lid.

### Vehicle search



While the vehicle is in arm mode, press .  
The turn signal lights will flash three times to indicate the location of the vehicle.

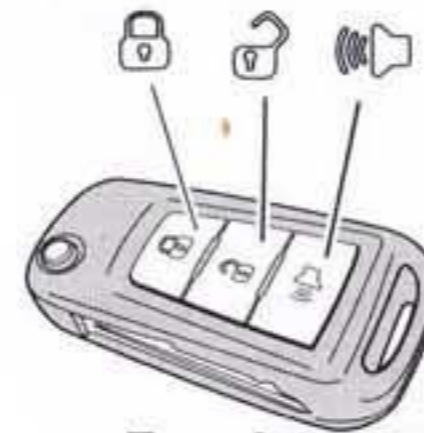

Type A



Type B

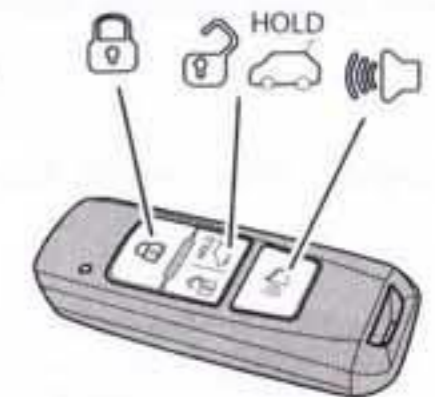

Type C

### Auto re-lock



When you press , the system will unlock all doors. If you do not open any doors, hood or trunk lid within 30 seconds, the system will re-lock all doors automatically.

### Double Stage Unlock

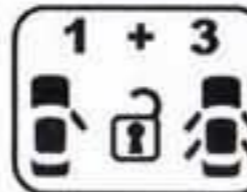

To change from central unlock mode to double stage unlock mode, press and simultaneously until the turn signal lights flash twice.

### In Double Stage Unlock mode

When you press , only the driver's door is unlock.

When you press again, the other three doors will unlock.

To change from double stage unlock mode to central unlock mode, press and simultaneously until the turn signal lights flash twice.



## Door operation and usage

### To open the door from inside

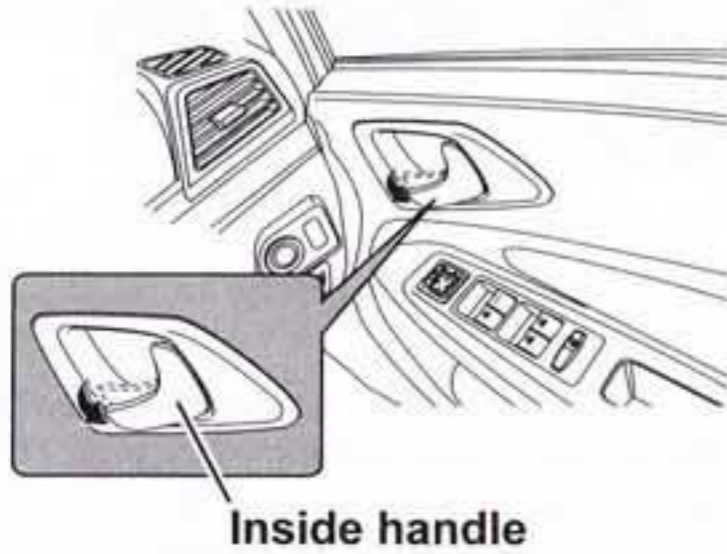

To open the door, pull the inside handle towards you.

#### In central lock mode

Pull the inside handle towards you twice;  
1st pull - all doors is unlock  
2nd pull - the door will open

### To open the door from outside

#### In case of emergency

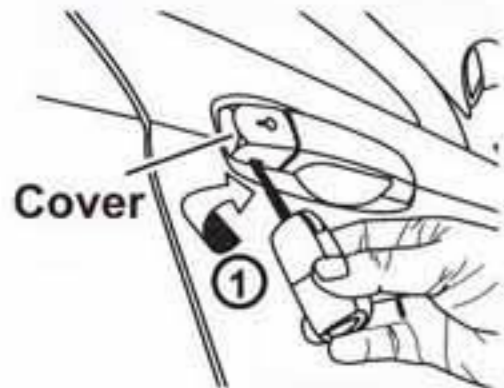

1 - Insert the key into the slot of the cover and twist. The cover will slightly open.



2 - Open the cover

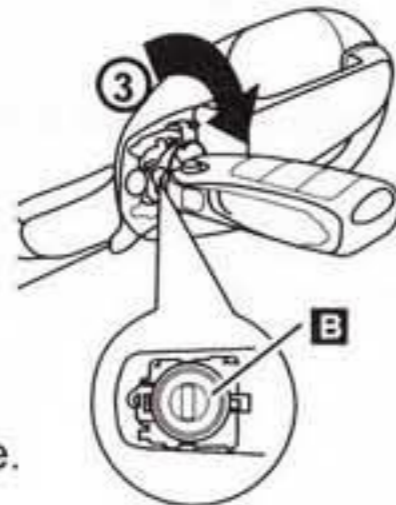

3 - To unlock, insert the key. Then, turn the key clockwise.

## USB, iPod and Aux connection

- A - Auxiliary (Aux) port
- B - USB port
- C - Power socket (12 V)
- D - USB port (1.5 A)
- E - USB port (2.1 A)

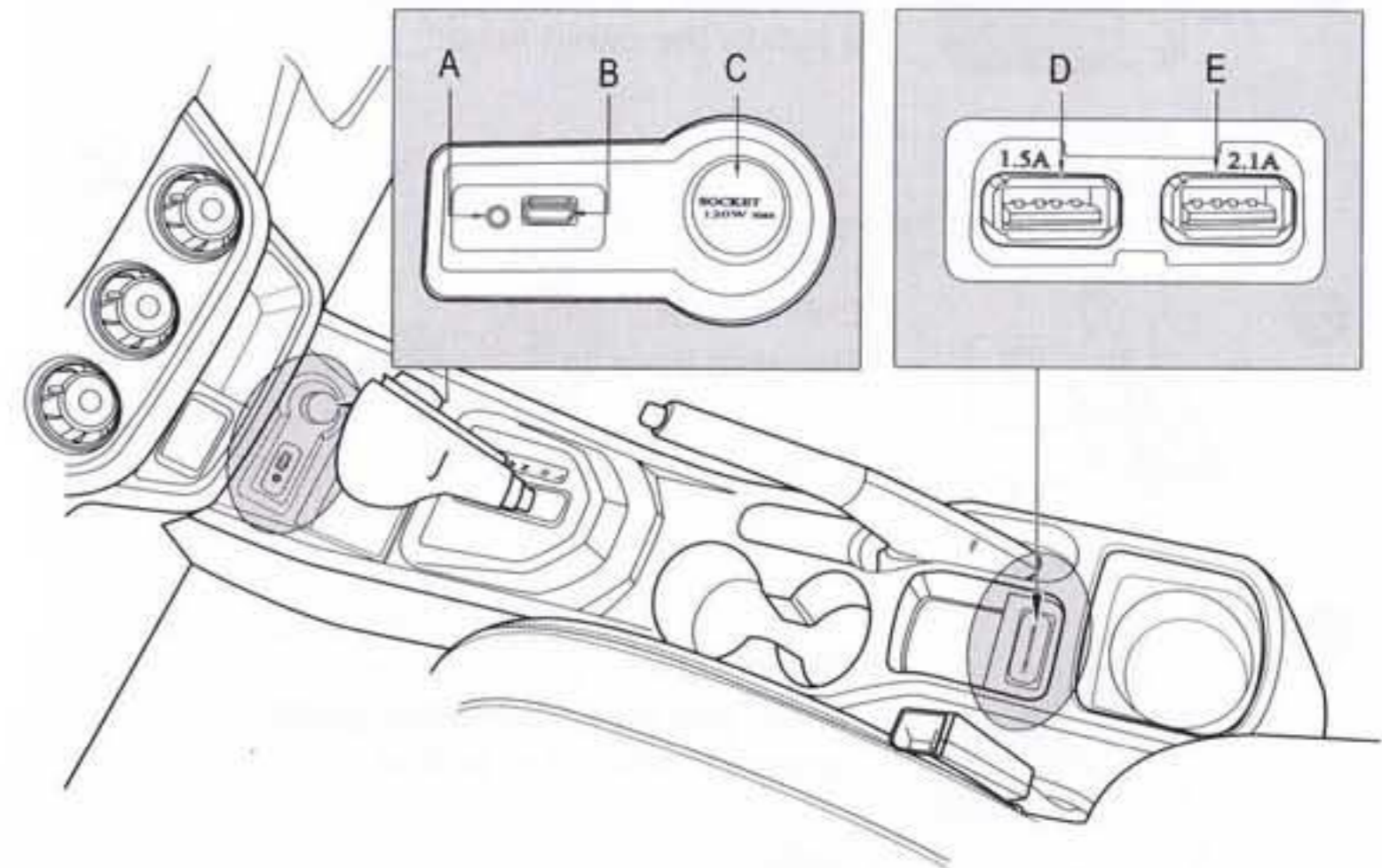

The USB and Aux ports are at the lower centre of the instrument panel.

To operate the USB and Aux ports, put the ignition switch in the ACC or the ON position.

## Start stop button (for some types)

### Important information

This vehicle has a gear shift lock for additional anti-theft security. Follow the instructions for maximum security.

### To START the engine

#### While the ignition is OFF;

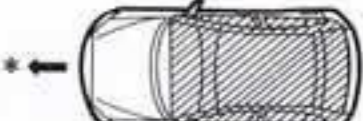
- 1  Make sure the remote transmitter is inside the cabin area.

\* : Forward direction

▨ : Operating range

( to start or turn off the engine )

- 2  CVT model :  
The shift lever in P position

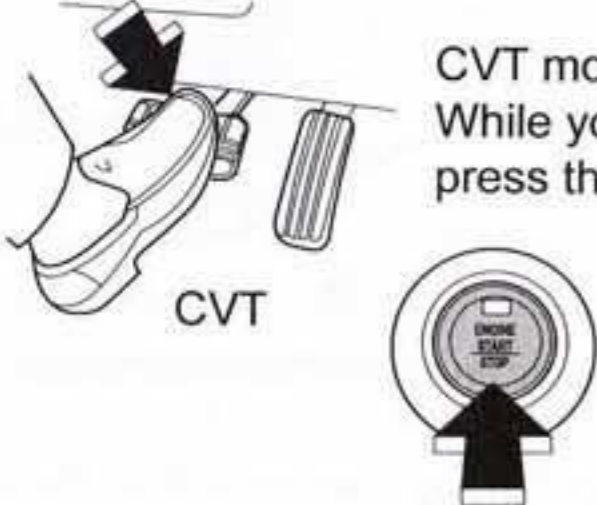
- 3  CVT model :  
While you press the brake pedal,  
press the start stop button.

### To TURN OFF the engine

#### While the engine is running;

- 1 CVT model : Put the shift lever in P position



- 2 Press the start stop button.

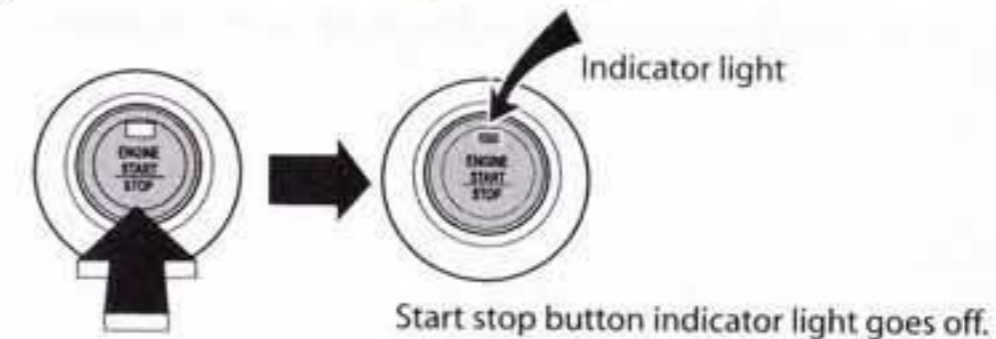

Make sure the indicator light is OFF.  
This condition indicates that the whole vehicle system  
is completely OFF.



## Keyless Entry System (for some types)

### Operating range

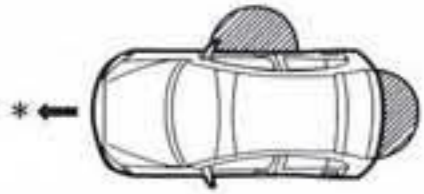

- \* : Forward direction
- ▨ : Operating range

Open the doors / trunk lid via Keyless Entry System  
Operating range : 1.2 ~ 1.5 metres

### Remote transmitter

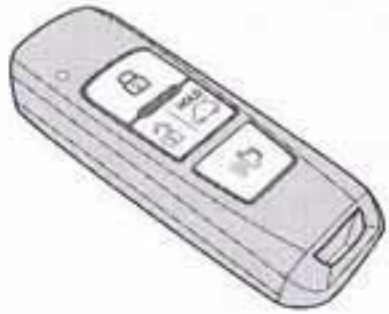

Make sure you carry the remote transmitter with you to operate the keyless entry system.

### Type C

### To open the door via keyless entry

**While the doors are locked;**

- 1) Make sure the remote transmitter is within the operating range.
- 2) Press the keyless entry switch on the outer door handle of driver door within the operating range and open the door.

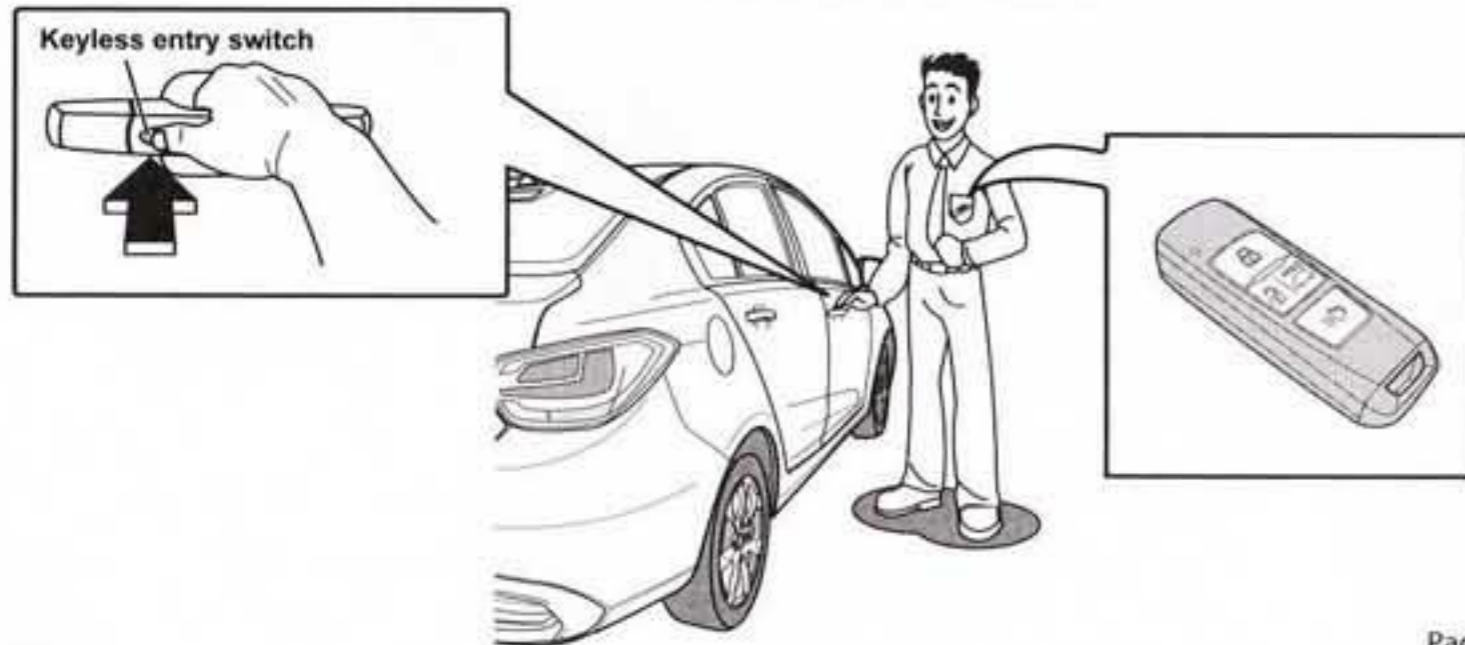

### To open the trunk lid via keyless entry

**While the doors are locked;**

- 1) Make sure the remote transmitter is within the operating range.
- 2) Press the keyless entry switch under the rear garnish.

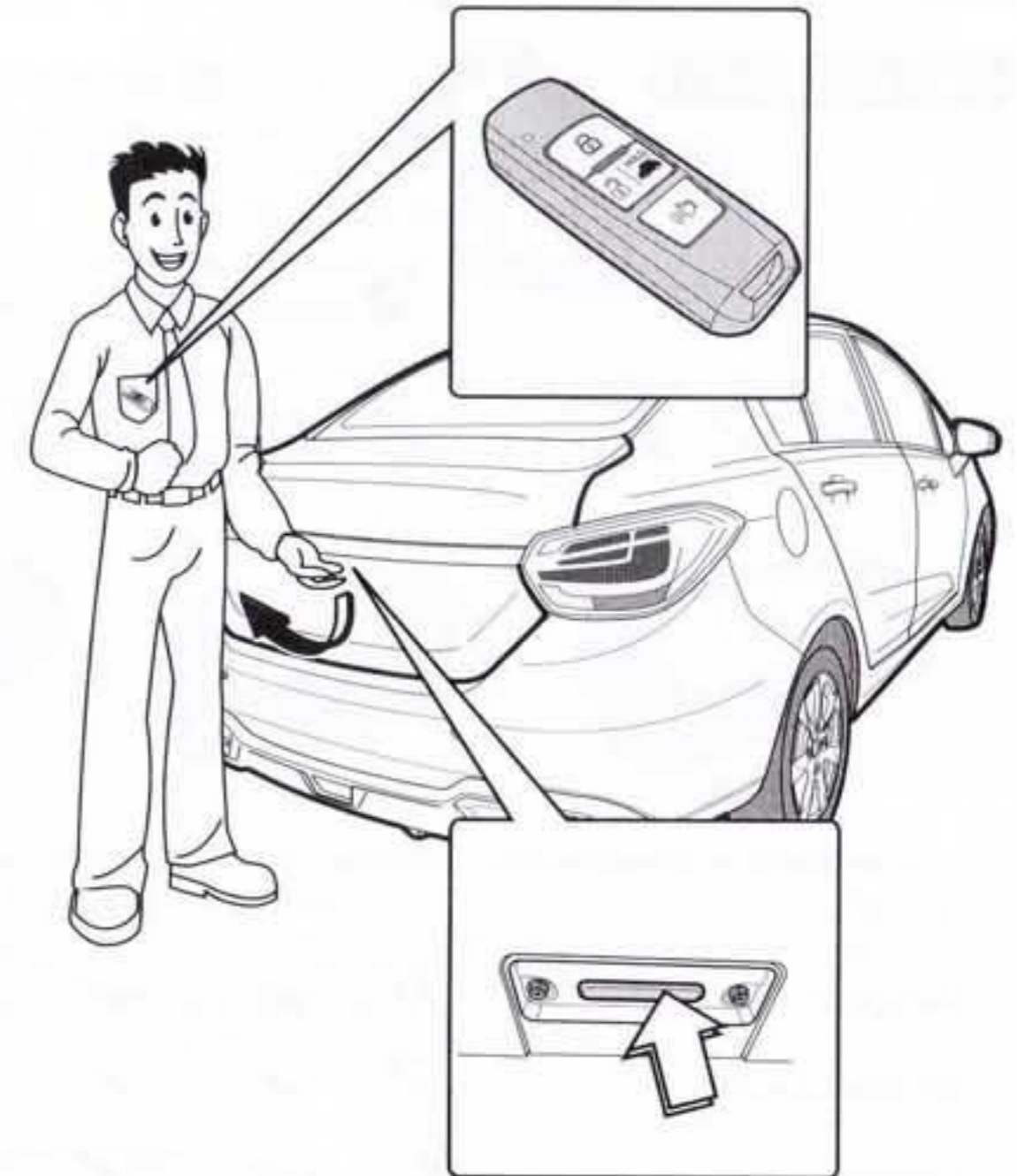

### Note

For other features which are not stated in this quick guide, please refer to the complete owner's manual for details.



Buku panduan ringkas ini diadakan bukan untuk menggantikan buku panduan yang utama. Pemilik perlu sentiasa merujuk kepada buku panduan utama untuk mendapatkan pemahaman yang lebih jelas bagi mengelakkan sebarang masalah ketika mengendalikan kenderaan ini dan membaca semua amaran dan peringatan yang tertera di dalam buku panduan utama.

### Alat kawalan jauh

#### Cara penggunaan

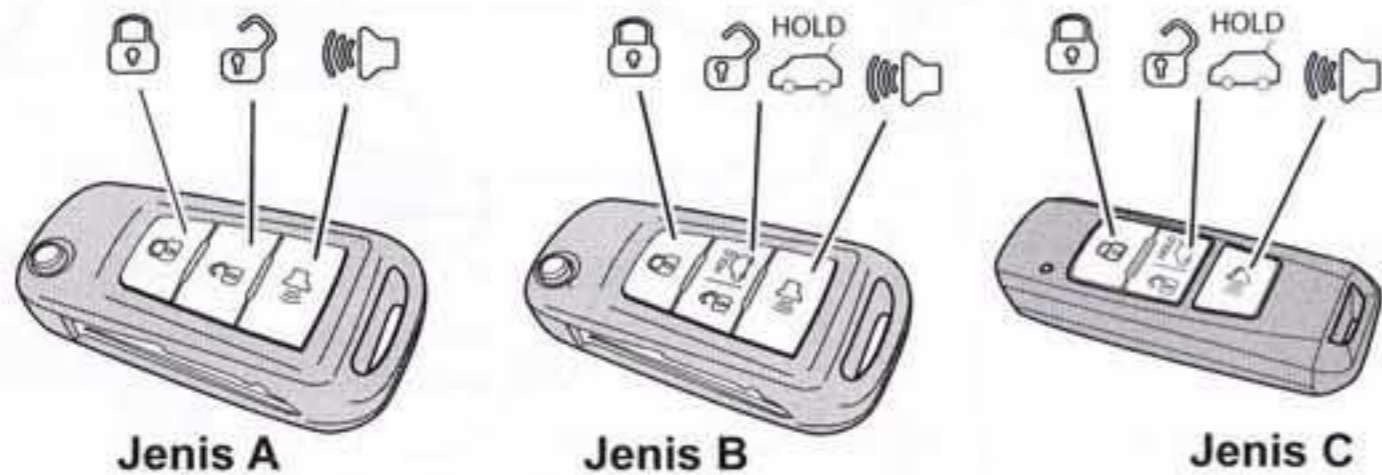

Ciri-ciri		Jenis A	Jenis B	Jenis C
Mengunci		✓	✓	✓
Membuka kunci		✓	✓	✓
Amaran panik		✓	✓	✓
Membuka penutup bonet belakang menggunakan alat kawalan jauh		Tidak dilengkapi	✓	✓
Akses tanpa menggunakan suis alat kawalan jauh atau kunci		Tidak dilengkapi	Tidak dilengkapi	✓

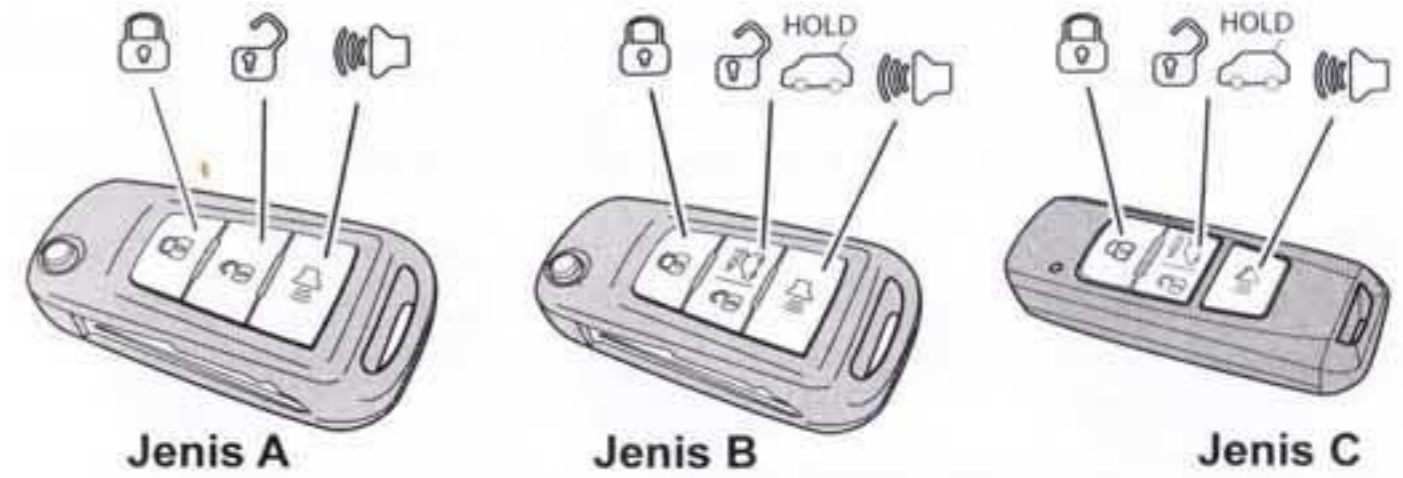

### Sistem alat kawalan jauh

#### Kunci / membuka kunci secara berpusat

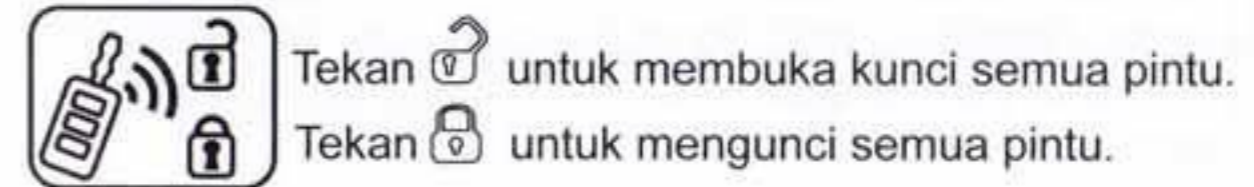

#### Amaran panik



#### Membuka bonet belakang (untuk sebahagian model)

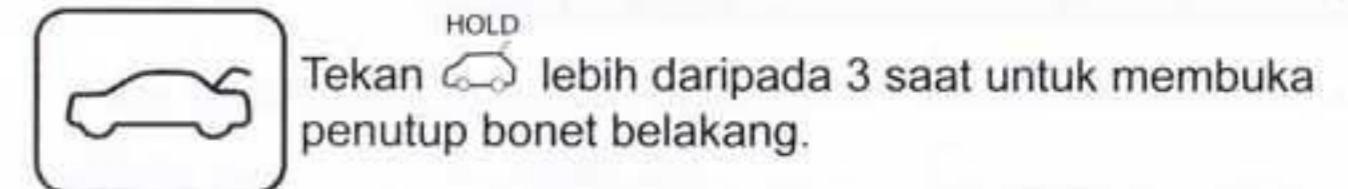

#### Pencarian kenderaan

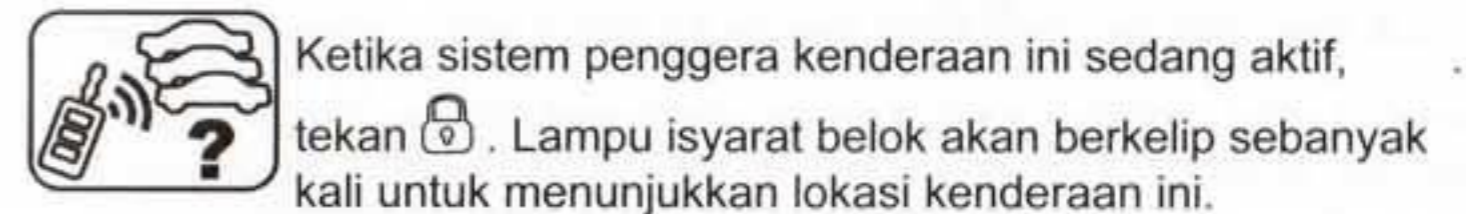



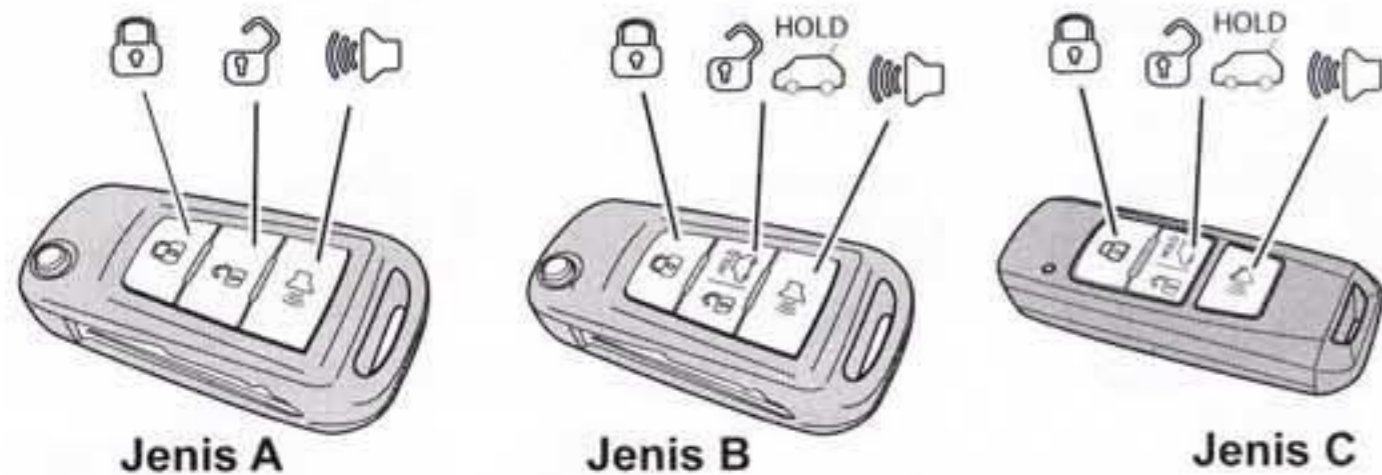



### Penguncian semula

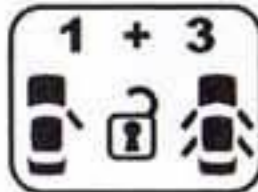

Apabila anda menekan  , semua pintu akan dibuka kunci. Jika tiada pintu, bonet hadapan atau bonet belakang dibuka dalam masa 30 saat, semua pintu akan dikunci semula secara automatik.

### Membuka kunci secara dua peringkat





Untuk menukar daripada mod membuka kunci secara berpusat kepada mod membuka kunci secara dua peringkat, tekan  dan  dengan serentak sehingga lampu isyarat belok berkelip sebanyak dua kali.

### Dalam mod membuka kunci secara dua peringkat

Apabila anda menekan  , hanya pintu pemandu akan dibuka kunci.

Apabila anda menekan  semula, ketiga-tiga pintu lain akan dibuka kunci.

Untuk menukar daripada mod membuka kunci secara dua peringkat

kepada mod membuka kunci secara berpusat, tekan  dan  dengan serentak sehingga lampu isyarat belok berkelip sebanyak dua kali.

## Pengendalian dan penggunaan pintu

### Membuka pintu daripada bahagian dalam

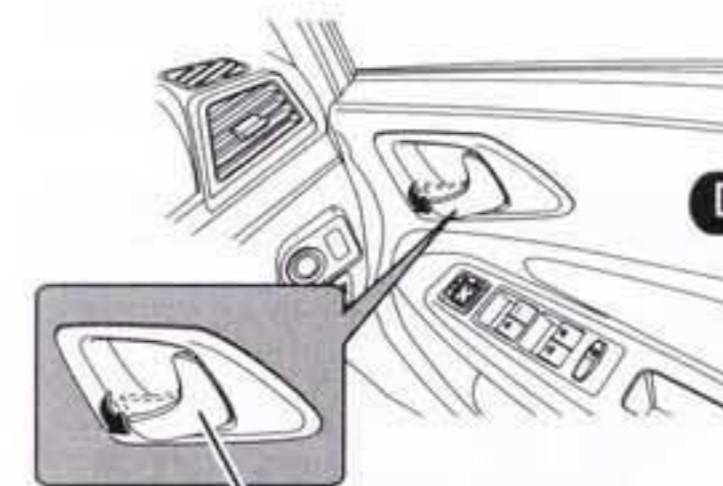

Tuil pada bahagian dalam pintu

Tarik tuil pada bahagian dalam pintu ke arah dalam. Pintu akan dibuka.

### Dalam mod kunci pintu secara berpusat

Tarik tuil pada bahagian dalam pintu ke arah dalam sebanyak dua kali; Tarikan pertama - Semua pintu akan dibuka kunci; Tarikan kedua - Pintu pemandu akan dibuka

### Membuka pintu daripada bahagian luar

#### Sewaktu kecemasan

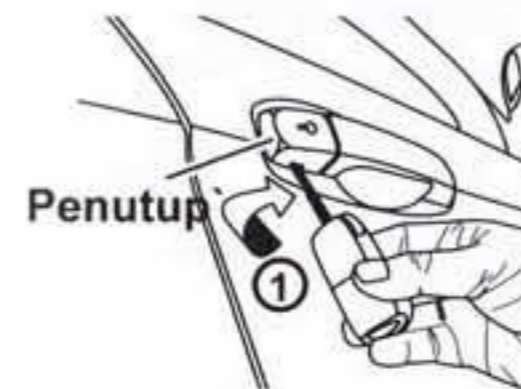

Penutup

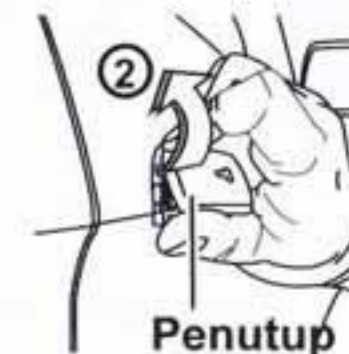

Penutup

2 - Buka penutup.

1 - Masukkan kunci ke dalam slot penutup dan pusing. Penutup akan terbuka sedikit.

3 - Untuk membuka kunci, masukkan kunci. Kemudian, putarkan kunci mengikut arah lawan jam.

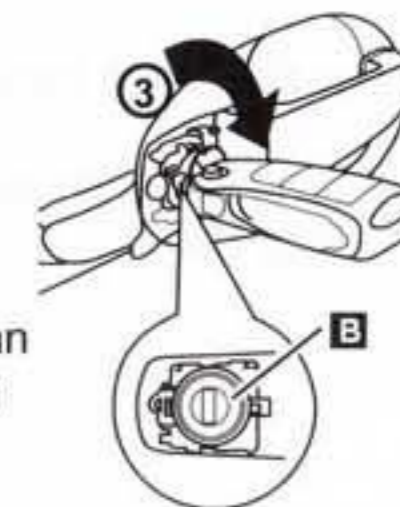



## Penyambungan USB, iPod dan Aux

- A - Input auxiliary (Aux)
- B - Input USB
- C - Soket kuasa (12 V)
- D - Input USB (1.5 A)
- E - Input USB (2.1 A)

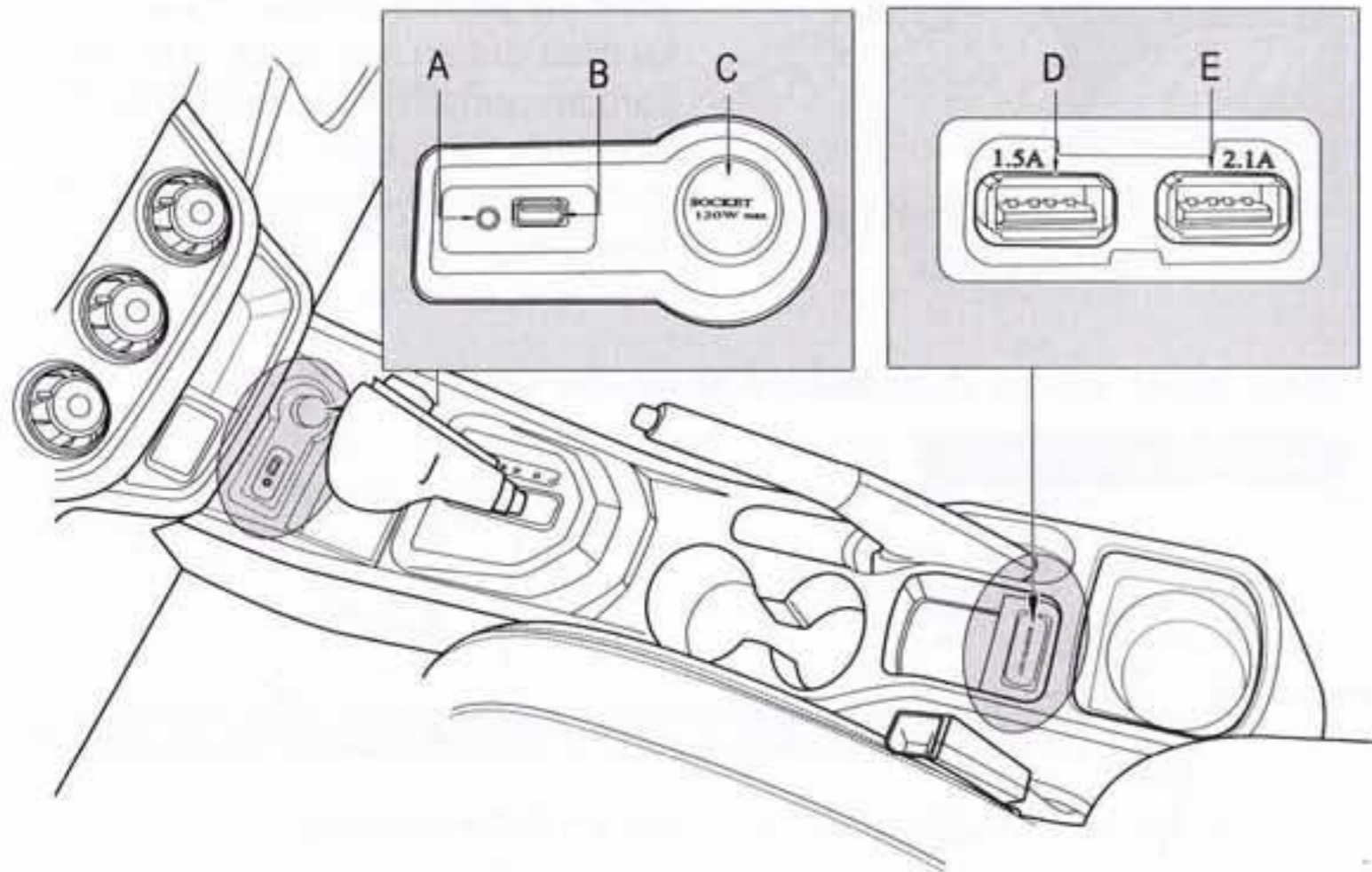

Input USB dan Aux terletak di bahagian tengah dan bawah panel instrumen.

Untuk menggunakan input USB dan Aux, letakkan suis penghidup enjin pada posisi ACC atau ON.

## Butang start stop (untuk sebahagian model)

### Maklumat penting

Kenderaan ini dilengkapi dengan kunci tuil penukar gear sebagai fungsi anti-kecurian tambahan. Ikuti arahan-arahan berikut bagi memastikan kenderaan ini mendapat perlindungan sepenuhnya.

### Cara menghidupkan enjin

**Ketika suis penghidup enjin pada posisi OFF;**

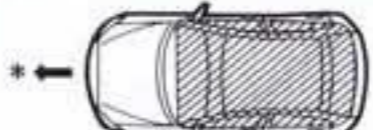
- 1  Pastikan alat kawalan jauh berada di dalam ruang kabin penumpang.

\* : Arah hadapan kenderaan  
▨ : Lingkungan kawasan operasi  
( untuk menghidupkan dan mematikan enjin )

- 2  Model CVT :  
Tuil penukar gear pada posisi P

- 3  Model CVT :  
Sambil menekan injak brek,  
tekan butang start stop.





## Cara mematikan enjin

**Ketika enjin masih hidup;**

- 1 Model CVT : Letakkan tuil penukar gear pada posisi P.



- 2 Tekan butang start stop.



Pastikan lampu penunjuk butang start stop dipadamkan. Keadaan ini menunjukkan keseluruhan sistem kenderaan telah dimatikan sepenuhnya.

## Sistem akses tanpa menggunakan suis alat kawalan jauh atau kunci (untuk sebahagian model)

### Lingkungan kawasan operasi



Membuka pintu / bonet belakang  
Lingkungan operasi : 1.2 ~ 1.5 metres

- \* : Arah hadapan kenderaan
- Lingkungan kawasan operasi

### Alat kawalan jauh

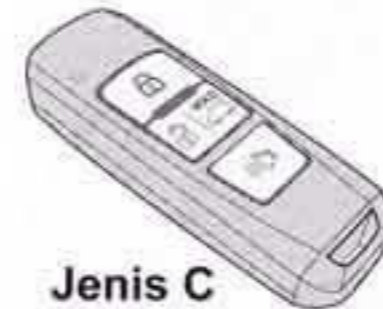

Pastikan anda bawa alat kawalan jauh bersama untuk mengendalikan sistem akses jenis ini.

### Membuka pintu dengan cara sistem akses ini

**Apabila pintu dalam keadaan terkunci;**

- 1) Pastikan alat kawalan jauh berada dalam lingkungan kawasan operasi.
- 2) Tekan suis keyless entry pada pemegang luar pintu pemandu dalam lingkungan kawasan operasi dan buka pintu.

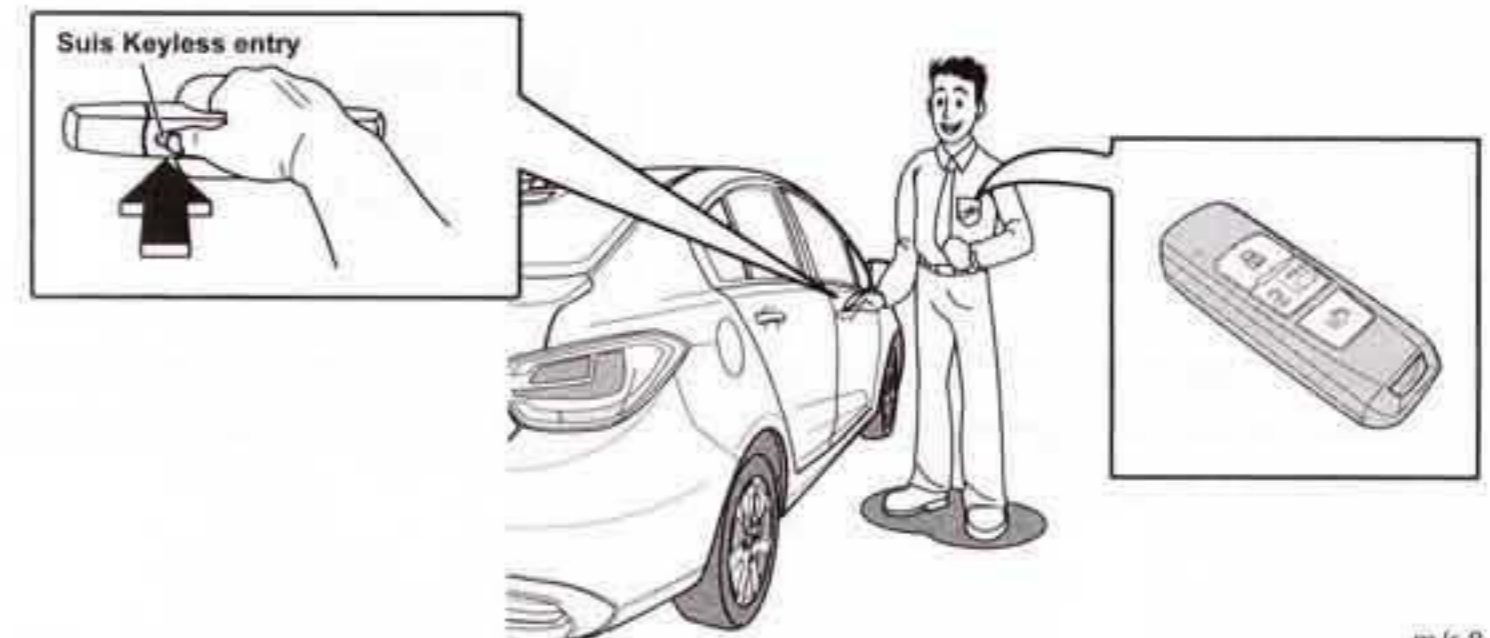



## Membuka bonet belakang

**Ketika pintu dalam keadaan terkunci;**

- 1) Pastikan alat kawalan jauh berada dalam lingkungan kawasan operasi.
- 2) Tekan suis keyless entry di bawah bahagian hiasan penutup bonet belakang.

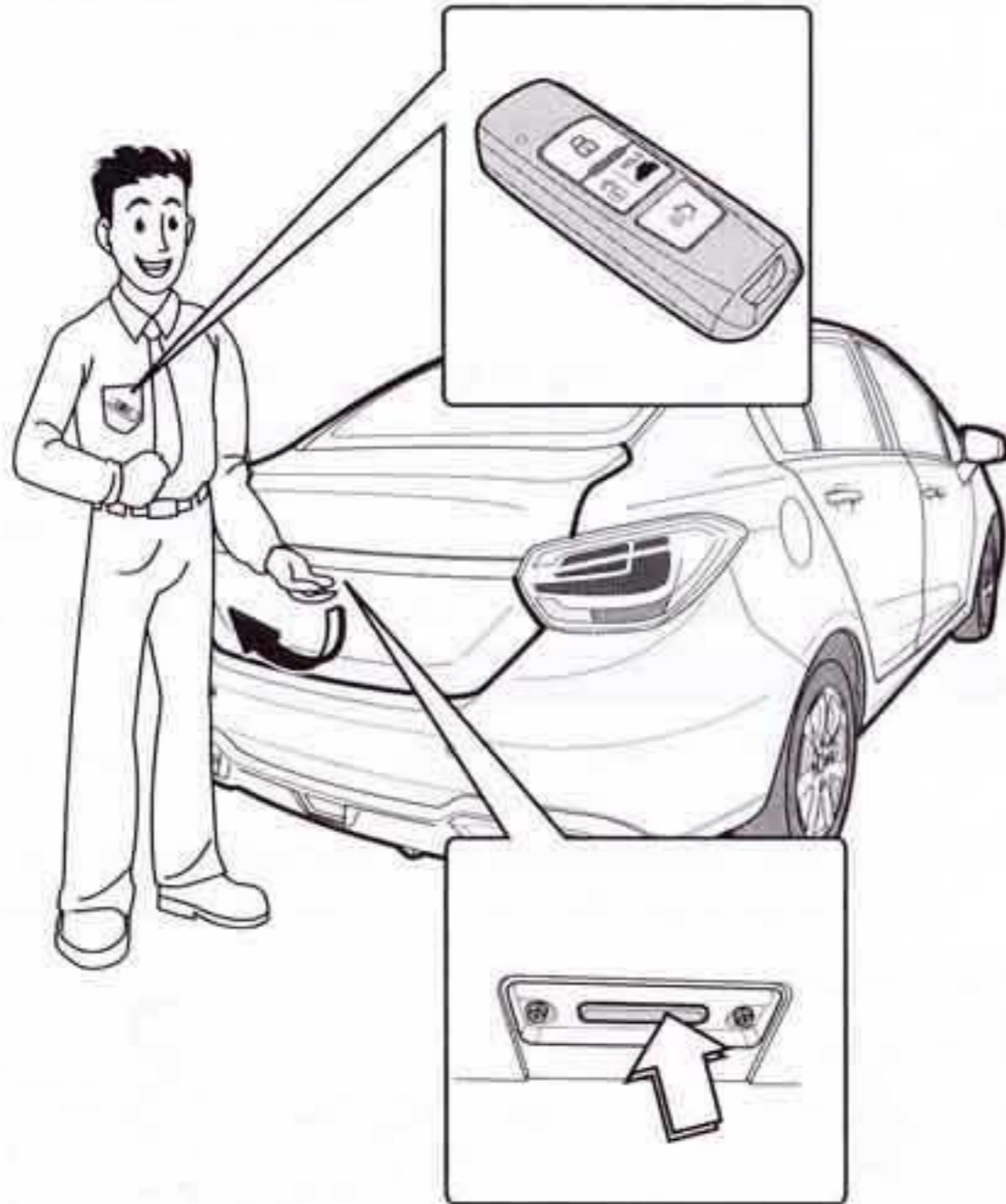

### Perhatian

Untuk maklumat bagi fungsi-fungsi lain yang tidak dinyatakan di dalam buku panduan ringkas ini, sila rujuk pada buku panduan utama untuk maklumat terperinci.