

## THROTTLE TENSION ADJUSTMENT

The tension of the remote control handle can be adjusted according to your preference. To increase the tension, turn the adjuster Ⓐ clockwise. To decrease the tension, turn the adjuster counterclockwise.

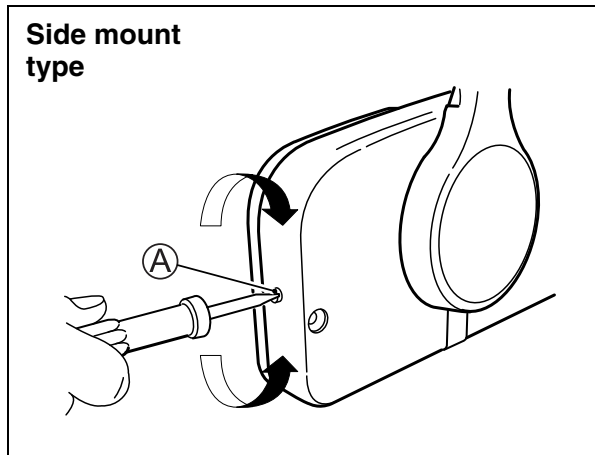

**NOTE:**

### **Top mount type**

When adjusting the tension of the remote control handle, consult your authorized Suzuki Marine Dealer.

## IDLE SPEED ADJUSTMENT

The idle speed has been factory adjusted between 650 – 750 r/min. in neutral.

**NOTE:**

If idle speed cannot be set within the specified range, contact your authorized Suzuki Marine Dealer.

## SETTING OF TILT UPPER LIMIT POSITION

If the outboard motor contacts the motor well of the boat during full tilt up operation, the upper limit setting should be reset.

Perform this set-up after the current position setting has been canceled, as explained in the following procedure.

## CANCELING THE TILT UPPER POSITION LIMIT SETTING

1. Turn the ignition key to the "ON" position.
2. Pull out the emergency stop switch lock plate.

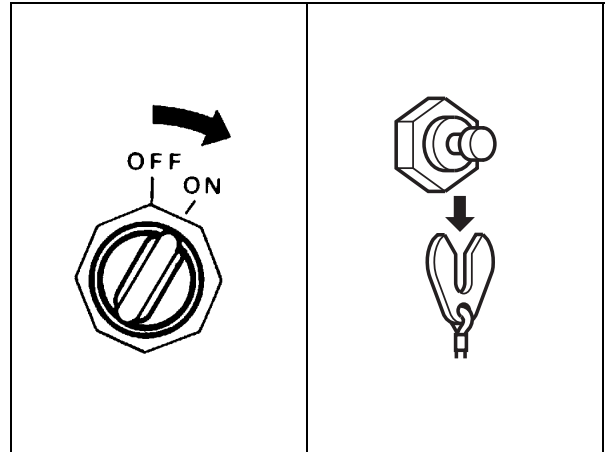

3. Make sure that remote control handle is in "NEUTRAL".

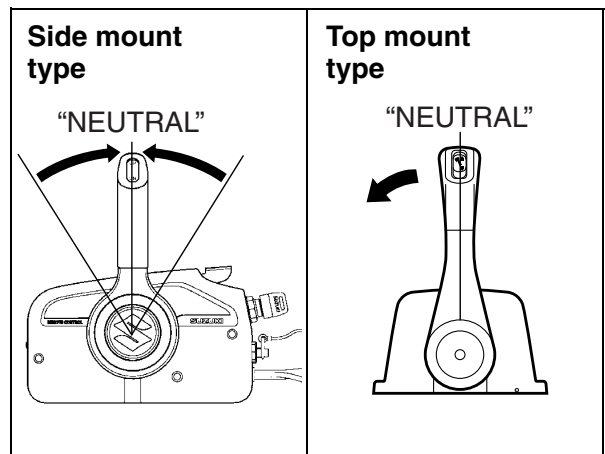

#### 4. Top mount type

Using the throttle only function of the remote control box, move the control handle forward until the caution buzzer sounds one time.

#### Side mount type

Using the throttle only function of the remote control box, move the warm-up lever upward until the caution buzzer sounds one time.

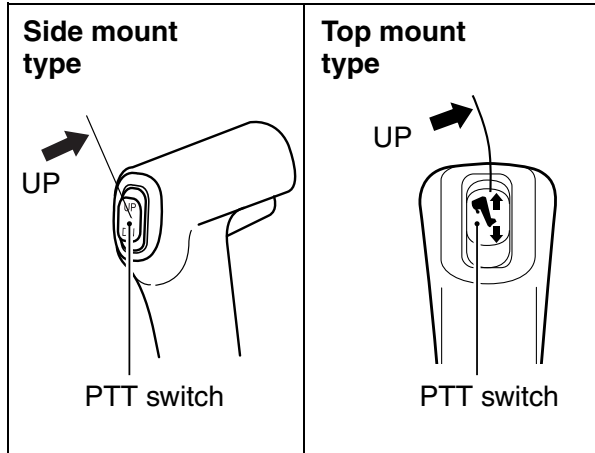

5. Press the “UP” side of the PTT switch for three seconds and the buzzer will sound twice briefly indicating the setting has been canceled.
6. Return the throttle to the fully closed position.

### SETTING THE TILT UPPER POSITION LIMIT

7. Press the “UP” side of the PTT switch so that the optimum full tilt up position for the boat can be obtained.
8. Turn the ignition key to the “ON” position.
9. Pull out the emergency stop switch lock plate.
10. Make sure that remote control handle is in “NEUTRAL”.

#### 11. Top mount type

Using the throttle only function of the remote control box, move the control handle forward until the caution buzzer sounds one time.

#### Side mount type

Using the throttle only function of the remote control box, move the warm-up lever upward until the caution buzzer sounds one time.

12. Press the “UP” side of PTT switch three times within three seconds. The buzzer will sound one time briefly indicating the setting has been accepted.
13. Return the throttle to the fully closed position and install the lock plate on the emergency switch. Operate the full tilt up and full down operations several times by pressing the PTT switch and check that the setting of both the trim lower limit and tilt upper limit are properly set.

### ⚠ WARNING

Setting of the tilt upper limit position will not prevent the outboard motor from tilting fully up and contacting the motor well if the motor’s lower unit hits an object at high speed. Such tilting could damage your motor and boat and injure the boat occupants.

Keep all occupants away from the motor when operating at high speed.