

SKYVIPER™

12+

V950-HD VIDEO DRONE HIGH DEFINITION

INSTRUCTION GUIDE CONTENTS

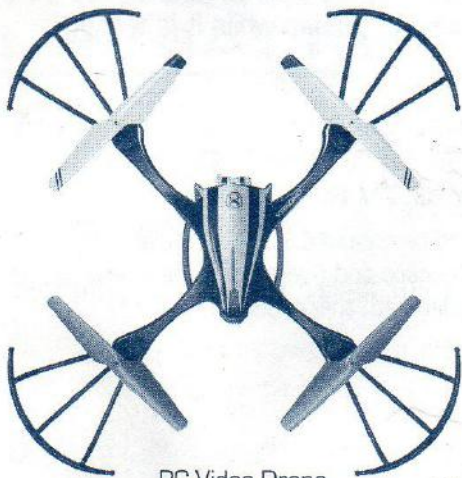

RC Video Drone



Remote Control



Screwdriver



Screws



Micro SD Card Adapter



Micro SD Card

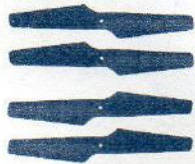

4 Replacement Blades

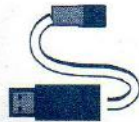

USB Charging Cable

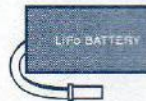

Rechargeable 3.7v
650mAh LiPo Battery

Battery door includes security screw to prevent child access to LiPo battery. Users over 14 years of age may remove screw from door for easier access.

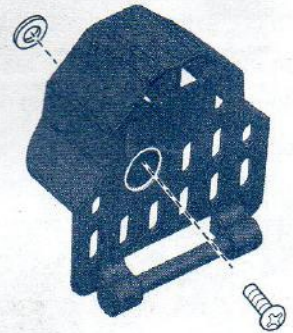

Remove all packaging attachments before giving the toy to a child.

Not suitable for children under 3 years due to small parts that could be swallowed.

BC

Conforms to product safety standards ASTM F963.

Keep instructions for future reference. Do not discard.



CAUTION: Consumers should confirm the lawful use of this product with local authorities as laws may vary.

This device complies with PART 15 of the FCC Rules. Operation is subject to the following two conditions. (1) This device may not cause harmful interference, and (2) this device must accept any interference received, including interference that may cause undesired operation.

CAUTION: Changes or modifications to this unit not expressly approved by the party responsible for compliance could void the user's authority to operate the equipment.

NOTE: This equipment has been tested and found to comply with the limits for a Class B digital device, pursuant to Part 15 of the FCC Rules. These limits are designed to provide reasonable protection against harmful interference in a residential installation. This equipment generates, uses and can radiate radio frequency energy and, if not installed and used in accordance with the instructions, may cause harmful interference to radio communications. However, there is no guarantee that interference will not occur in a particular installation. If this equipment does cause harmful interference to radio or television reception, which can be determined by turning the equipment off and on, the user is encouraged to try to correct the interference by one or more of the following measures: Reorient or relocate the receiving antenna - Increase the separation between the equipment and receiver - Connect the equipment into an outlet on a circuit different from that to which the receiver is connected - Consult the dealer or an experienced radio/TV technician for help.

INSTALLING PROTECTIVE BLADE GUARDS

Install protective blade guards for indoor flying.

- 1 Insert the posts of the blade guards into the holes of the drone.
- 2 Secure the blade guards with the retaining screws.

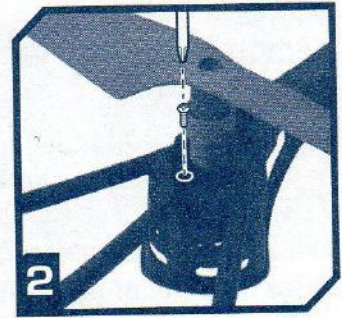

CHARGING, INSTALLING & CARING FOR LIPO BATTERY IN THE DRONE

- 1 Unscrew the battery screw and open the battery compartment door on the rear side of Drone.
- 2 Disconnect battery wires.
- 3 Pull LiPo battery out of back of Drone.
- 4 Plug charging cord into a computer or USB power block.
- 5 Plug LiPo battery into Charging Cord.
RED LIGHT = CHARGING
GREEN LIGHT = FULLY CHARGED
- 6 Charge battery until full.
- 7 Once charged, disconnect LiPo battery from USB port.
- 8 Unplug charging cord from USB power source.
(Always unplug when not in use).
- 9 Insert LiPo battery into back of Drone.
Reconnect the battery wires.
Close the battery compartment door.

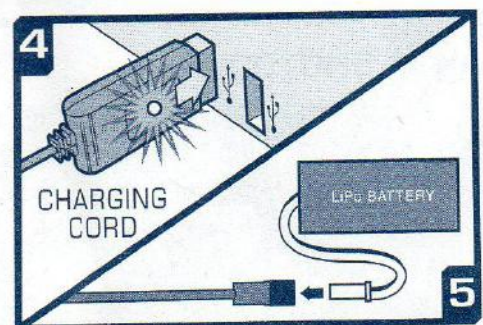
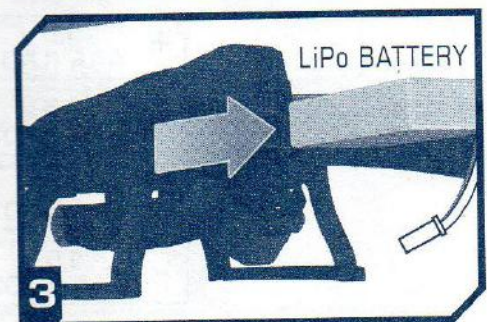
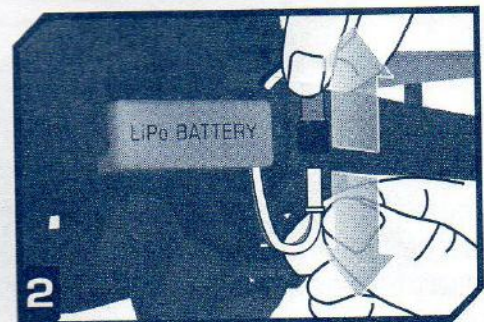
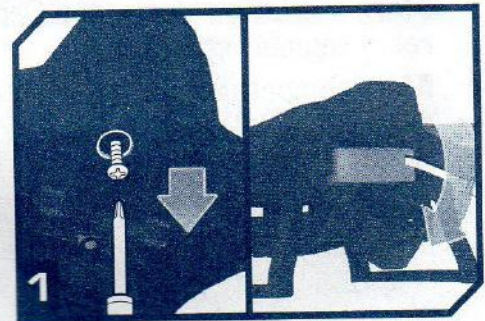

NOTE:

Always unplug LiPo battery when Drone is not in use.

CHARGING PRECAUTIONS:

After use, allow LiPo battery to cool down to room temperature before charging again.

- Charge LiPo battery in an isolated area, away from excessive heat or moisture.
- If LiPo battery swells, unplug it immediately and permanently discontinue use.
- Do not modify, heat, or wet the battery in any way. Only recharge with provided charger.

WARNING!

IF AT ANY TIME DURING CHARGING OR USE THE BATTERY BECOMES DAMAGED IN ANY WAY, DISCONTINUE CHARGING OR USE OF THE BATTERY IMMEDIATELY.

Continuing to charge or discharge a battery that has been damaged can result in a fire. Quickly and safely disconnect the Drone from charging and place away from flammable materials. Observe the battery for at least 30 minutes to be certain no additional swelling or rupture occurs. Completely discharge the battery by submerging it in a saltwater solution (1/2 cup salt per gallon of water) for 24 hours. Check your local laws and regulations for correct recycling and/or battery disposal.

WHEN NOT IN USE:

- Always **UNPLUG** the Drone's LiPo battery when not in use or when Drone is being stored or transported.
- Store the LiPo battery and Drone in a dry area at room temperature.
- Avoid temperatures less than 40°F/4°C and greater than 120°F/49°C.
- Do not leave the LiPo battery in a car or exposed to direct sunlight. If exposed to temperatures greater than 120°F/49°C, the LiPo battery can be damaged or may catch fire.

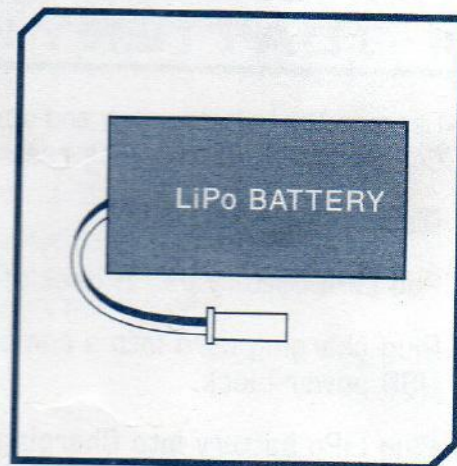

INSTALLING REMOTE BATTERIES

Loosen screw in the Remote Control battery compartment door with Philips screw driver and insert batteries as shown. Replace door and tighten screw.

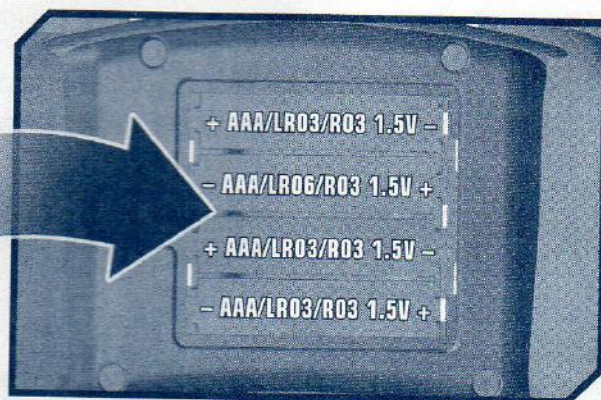
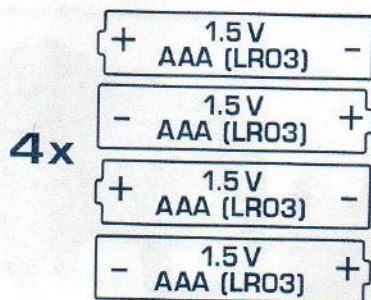

AUTO SHUTDOWN:

- If battery voltage drops to an extremely low level, Drone will automatically shutdown. The Video Drone will need to be recharged to restore flying power.
- If anything prevents Drone's blades from spinning or they become jammed, Drone will automatically shutdown. The LiPo battery will need to be unplugged, then reconnected to restore flying power.

FLIGHT SENSITIVITY ADJUSTMENT

Drone responsiveness may be adjusted on the Controller to match your flying skills.

There are three choices:

1. LOW – 2. MEDIUM – 3. HIGH SENSITIVITY

It is best to start in **LOW POSITION** until you have mastered flying.

Flight sensitivity can be adjusted before or during flight.

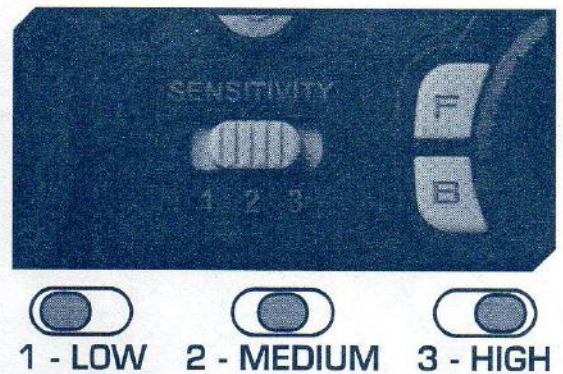

CALIBRATING & LAUNCHING

- 1 Turn **OFF** Remote Control.
- 2 Open battery compartment door and unplug the Drone LiPo battery. Disconnect by pulling connectors apart—**Do not pull wires.**
- 3 Reconnect Drone LiPo battery. Close battery compartment door.
- 4 Quickly place Drone on **FLAT LEVEL SURFACE**.
- 5 Turn Remote Control **ON**.
- 6 Slowly push remote control **THROTTLE STICK UP** until Drone lifts into the air.

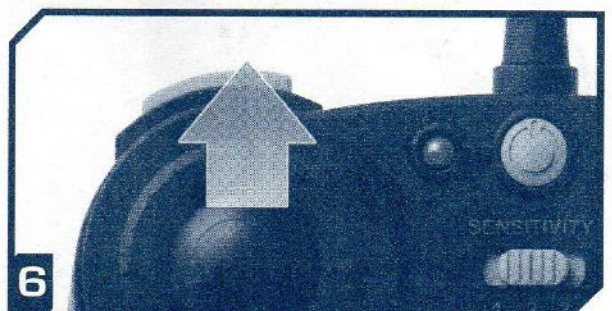
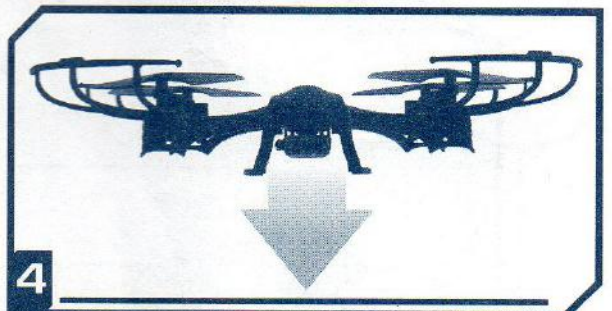
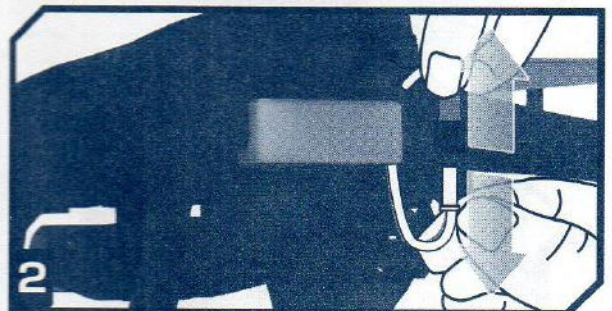
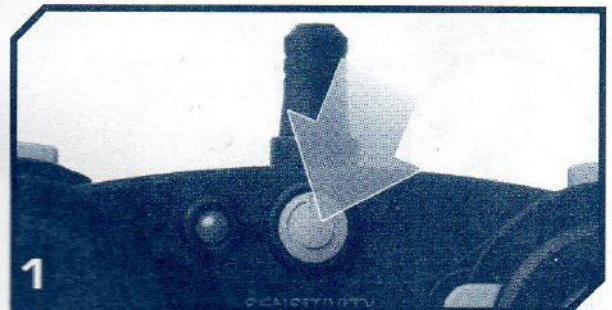

IMPORTANT: YOU ONLY HAVE A FEW SECONDS AFTER THE LIPO BATTERY IS PLUGGED IN TO PLACE DRONE ON A LEVEL SURFACE FOR PROPER CALIBRATION. IF DRONE DOES NOT RISE TO A STABLE HOVER OR FLIES ERRATICALLY, REPEAT STEPS 1 THROUGH 6.

CAUTION: NEVER APPROACH DRONE WHILE THE PROPELLER BLADES ARE STILL SPINNING. THROTTLE DOWN UNTIL THE BLADES STOP THEN TURN OFF REMOTE BEFORE ATTEMPTING TO HANDLE DRONE.

Familiarize yourself with Drone's controls before flying!

THROTTLE/ROTATION STICK

- To make the Drone **LIFT**, press the THROTTLE STICK **FORWARD**.
- The further you **PUSH** the THROTTLE STICK, the faster you **LIFT**.
- To make the Drone **HOVER**, find the sweet spot on the THROTTLE STICK (somewhere in the middle).

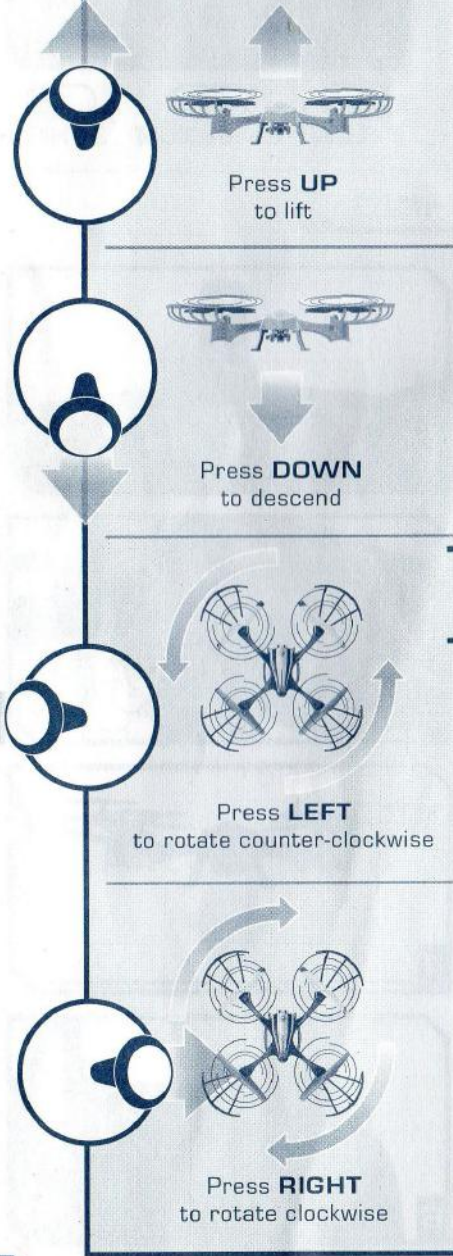

Power On/Off Switch

Power indicator LED

STUNT Button

THROTTLE/
ROTATION STICK

Rotation Trim

Flight Sensitivity Switch

Forward/Backward Trim

Video Button

Photo Button (Behind)

DIRECTION STICK

Left/Right Trim

DIRECTION STICK

- Push the DIRECTION STICK **FORWARD** to fly forward, or away from you. (Green blades in front) Push **BACKWARD** to fly backward. The farther you push, the faster Drone flies in that direction.
- Push the Direction stick **LEFT** to fly left. Push **RIGHT** to fly right. The farther you push, the faster Drone flies sideways.

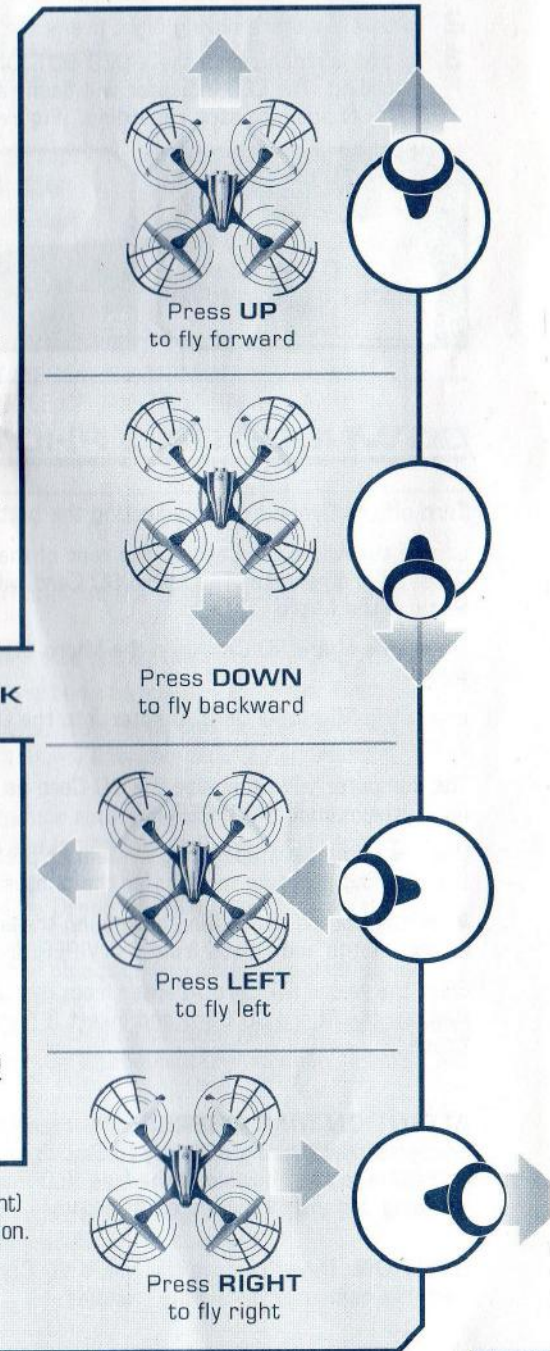

TAKING PHOTOS AND RECORDING VIDEOS

- 1 Insert the SD Card into the Drone.
- 2 To take a picture during flight press the PHOTO BUTTON on the REMOTE. (Figure 2)
- 3 To take a video press the VIDEO BUTTON (front button) on the REMOTE to start recording. The LED indicator will flash rapidly when recording. Press the VIDEO BUTTON again to stop recording. (Figure 3)



DOWNLOADING PHOTOS AND VIDEOS

Turn off the Drone by disconnecting the battery.

Locate the Micro SD Card on the rear of the Drone. Press in and release. The Micro SD Card will pop out. Remove the Micro SD Card.

Insert the Micro SD Card into the Micro SD Card Adapter.

Insert the Micro SD Card Adapter into the USB port on your computer.

The computer will recognize the SD Card as an external hard drive named SKYVIPER.

Use the computers operating system or preferred photo transferring program to transfer the photos and videos.

After the photos and videos have been transferred, delete photos and videos from SKYVIPER drive.

Eject the Micro SD Card Adapter from the USB Port. Remove the Micro SD Card and insert it back into the Drone.

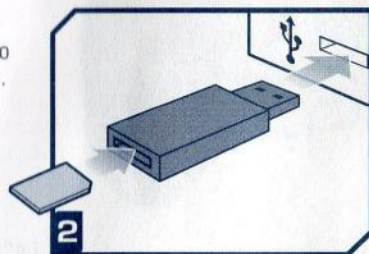
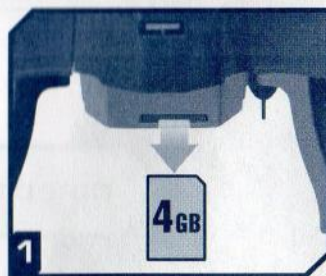

ATTENTION MAC USERS: If you experience problems downloading and playing Sky Viper videos using Quicktime, please download the free VLC Player at the following link: <http://vlc.install-free.com/>

CAUTION: Never remove the Micro SD Card Adapter from the computer during file transfer.

"GET MORE RECORDING TIME"

YOU MAY UPGRADE TO LONGER RECORDING TIMES BY REPLACING THE 4GB MICRO SD CARD WITH HIGHER CAPACITY MICRO SD CARD - UP TO 32GB (SOLD SEPARATELY).

TRIM ADJUSTMENTS

If Drone drifts in any direction while hovering (and you are not pressing the Direction stick), you may need to make trim adjustments. Safely land Drone on a level surface. Press the recommended Trim button once as described below. Launch the Drone back into the air and attempt another still hover. If Drone continues to drift, repeat the process until a still hover is achieved:

- Drone drifts forward
– Press the **B** button
- Drone drifts backward
– Press the **F** button
- Drone drifts to the left
– Press the **R** button
- Drone drifts to the right
– Press the **L** button
- Drone spins counter-clockwise, when viewed from the top
– Press the **↺** button
- Drone spins clockwise, when viewed from the top
– Press the **↻** button

NOTE: THE REMOTE WILL BEEP/FLASH 3 TIMES WHEN TRIM ADJUSTMENT IS SET TO THE NEUTRAL POSITION (THE MIDDLE OF THE TRIM RANGE) AND BEEP ONCE WHEN IT HAS REACHED THE END OF IT'S RANGE.

FLYING TIPS

- When launching the Drone, face the same direction as the Drone. Green blades and Green LEDs should be in front.
- Practice launching, hovering and landing before attempting to learn other moves.
- Flying 2 to 3 feet above the ground will reduce ground turbulence and make flying easier.
- When first attempting to fly in different directions, start by tapping the Direction stick until you have a feel for it. Always move the controls slowly until you become comfortable operating the Drone.
- Once you've mastered flying in directions, practice rotational controls. Spinning and keeping Drone facing the same direction you are facing makes flying easier and more intuitive.
- Stay 2 to 3 feet away from walls and ceilings as Drone will be drawn towards them if you fly too close.
- If propeller blades come in contact with another object or you crash, throttle down immediately to prevent possible or further damage.
- If anything prevents Drone's blades from spinning or they become jammed, **THROTTLE DOWN IMMEDIATELY**. Do not attempt to fly until obstruction has been removed and damage fixed.
- Should something prevent Drone's blades from spinning, Drone may **AUTO SHUTDOWN**. LiPo battery will need to be unplugged then reconnected to restore flying power.
- If the Drone flies too far away, beyond the control range of the remote, the Drone will **AUTO-LAND** to prevent the Drone from flying away out of control.

ONE TOUCH STUNTS

IMPORTANT

REMOVE THE CAMERA UNIT FROM THE DRONE BEFORE PERFORMING STUNTS. STUNT FUNCTIONS WILL NOT WORK WITH CAMERA UNIT ATTACHED.

BARREL ROLL

While flying forward (or reverse), press the **STUNT BUTTON**.

NOTE: Once a stunt has been initiated, DO NOT adjust Throttle or press any other controls until the stunt has been completed.

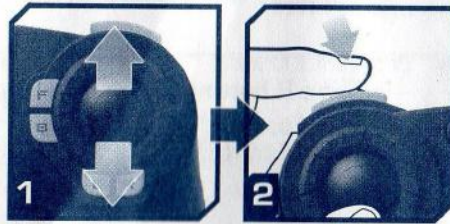

FLIP

- 1 Bring the Drone to a mid air hover without flying in any direction. Remove finger from the **DIRECTION STICK**
- 2 While **HOVERING**, press and hold the **STUNT BUTTON**.
- 3 While still holding the **STUNT BUTTON**, tap the **DIRECTION STICK** in the direction you want the drone to flip.

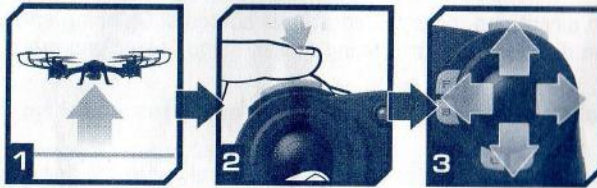

RIGHT FLIP



FRONT FLIP

360° PANORAMIC VIEW ROTATION

Attach the camera unit to the Drone.

- 1 While **HOVERING**, press and hold the **STUNT BUTTON**.
- 2 **DIRECTION STICK** (Right or left)
- 3 Press the **RECORD BUTTON** to start recording. Press again to stop recording.



CHANGING DAMAGED PROPELLERS

- 1 Unplug LiPo battery on Drone.
- 2 Make note of the blade color and letter (A or B) before removing the blade from Drone. (Markings are located on the underside of blades and Drone). Green blades are front, grey blades are rear.
- 3 Remove the small screw using the mini screwdriver provided.
- 4 Replace the damaged blade with a new blade with matching color and letter. Secure the blade with the retaining screw.

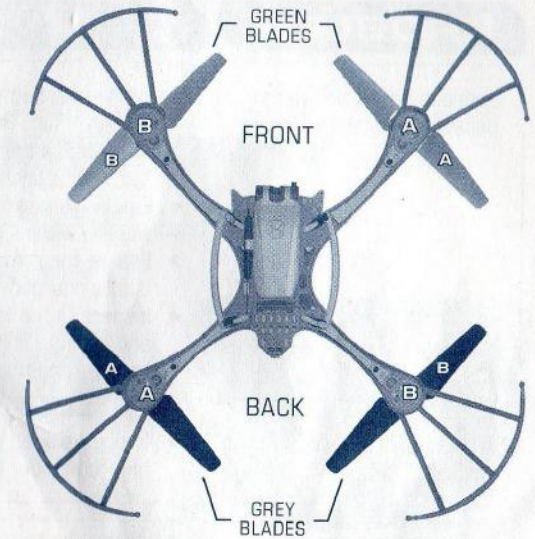

Bottom View of Drone

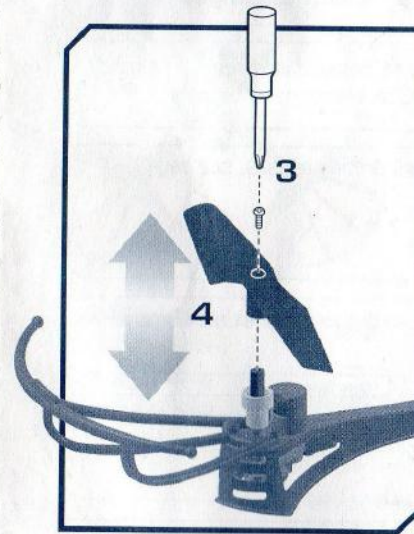

WARNING: Do not fly with broken or damaged propeller blades as it may cause damage or lead to injury.

MAINTENANCE

Over time, loose hair or carpet fibers may get wound in blades, reducing performance. Unplug Drone and remove fibers from motors. (Remove blades if necessary)

CAUTION!

Drone should be flying at least 9 feet in the air with a minimum clearance of 9 feet in all directions before attempting stunt functions. STUNT FUNCTIONS SHOULD BE PERFORMED OUTSIDE ONLY.

TROUBLESHOOTING

PROBLEM

SOLUTION

Drone is unresponsive or behaving erratically

- Drone may be miscalibrated by launching from an unlevel surface. Turn the remote off and unplug Drone's battery for 30 seconds then turn them back on and try again from a flat, level launching surface.
- Ensure your remote is within unobstructed view of Drone and you are within 30 feet range.
- Ensure the remote has fresh batteries and the LiPo battery is fully charged.
- Inspect Drone for any possible damage. Turn the remote off and unplug Drone's battery for 30 seconds then turn them back on and try again from a flat, level launching surface.

All blades spin, but Drone will not fly properly

- Drone's blades may have been installed incorrectly. Reinstall and remember that the GREEN blades point forward.

Drone drifts in any direction during flight without direction from the remote

- Adjust the trim controls until drifting ceases, see page 8.

Drone crashes immediately

- Propellers may be installed in the wrong position. Ensure proper installation.

Drone crashes when attempting stunt functions

- Ensure that Drone is flying a minimum distance of 9 feet from the ground with a minimum 9 feet clearance in all directions.

Photos/Videos will not transfer

- Ensure that Micro SD card Adopter is fully plugged into computer.
- Consult your computer's user guide for downloading data from external source.

Stunt button does not work

- Be sure to remove the camera unit from the Drone.

www.skyrockettoys.com/products/sky-viper

#skyviper



Customer Service :
888-674-5650

